

Bolted Storage Silos for Bulk Solids SPG 35

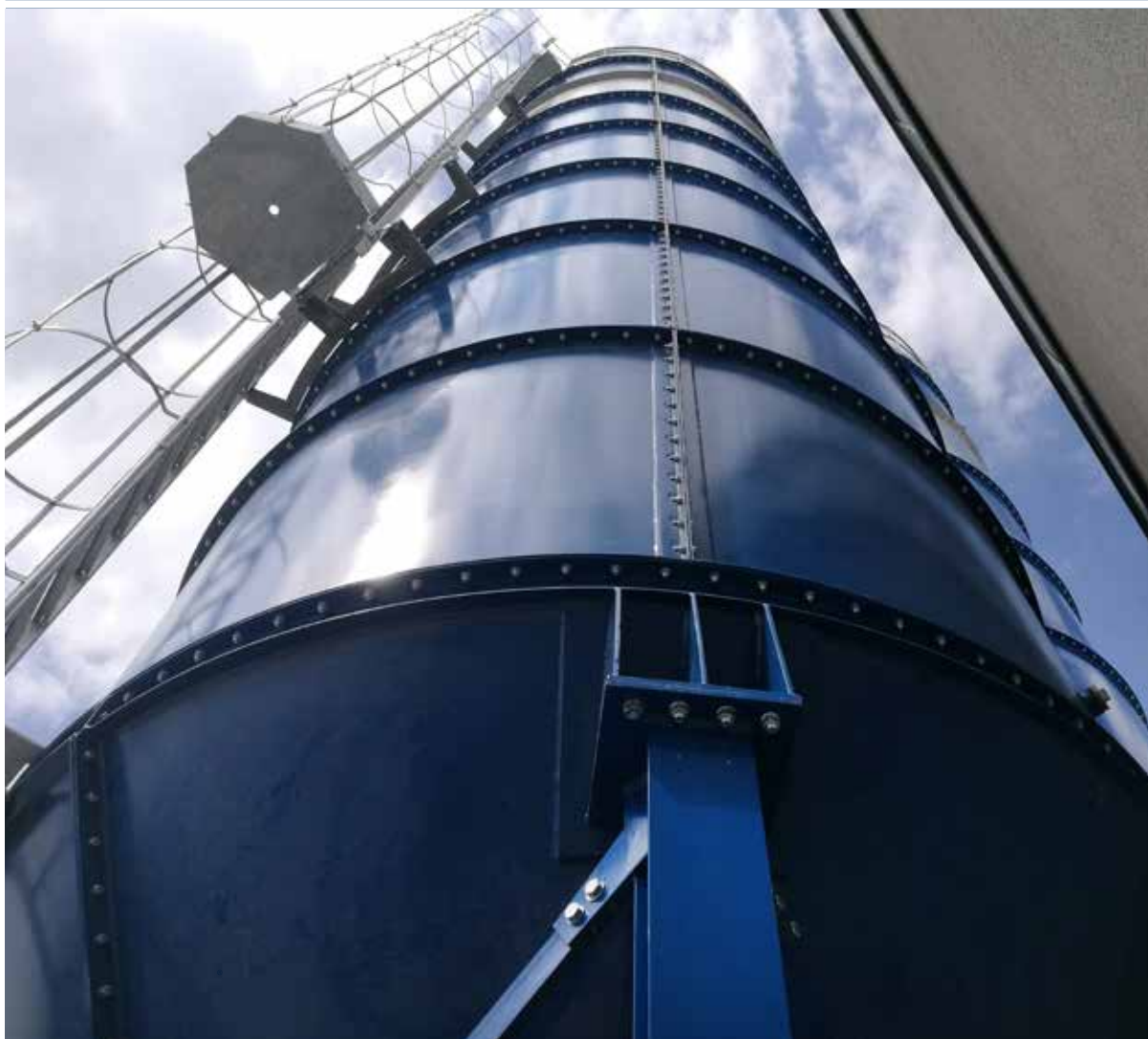

THE IDEAL SOLUTION FOR BULK SOLIDS STORAGE

SPG 35 is a range of 3,500mm-diameter silos made up of modular segments for on-site assembly. Designed for economic shipping, SPG 35 silos require short assembly time and minimum maintenance ensuring significant cost reduction.

The design of the SPG 35 series complies with all relevant regulations in force regarding safe storage of any type of powdery or granular material used in storage and processing plants.

The silos are designed and engineered according to the standards in force related to wind, snow, and seismic risk areas zone 1 (0.40g) and zone 2 (0.25g). Packing is designed to minimise shipping costs.

Overall Dimensions

ZS1

Seismic Zone 1 Silos for high seismic risk areas.
Featuring increased thickness (0.40g) and round pipe legs.

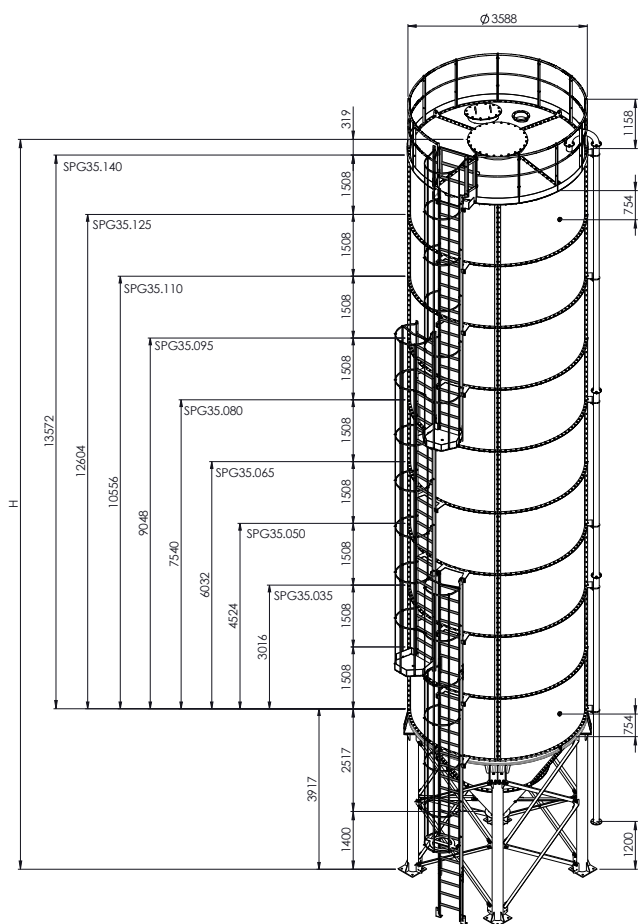

ZS2

Seismic Zone 2 Silos for low seismic risk areas.
Featuring standard thickness (0.25g) and HEA profile legs.

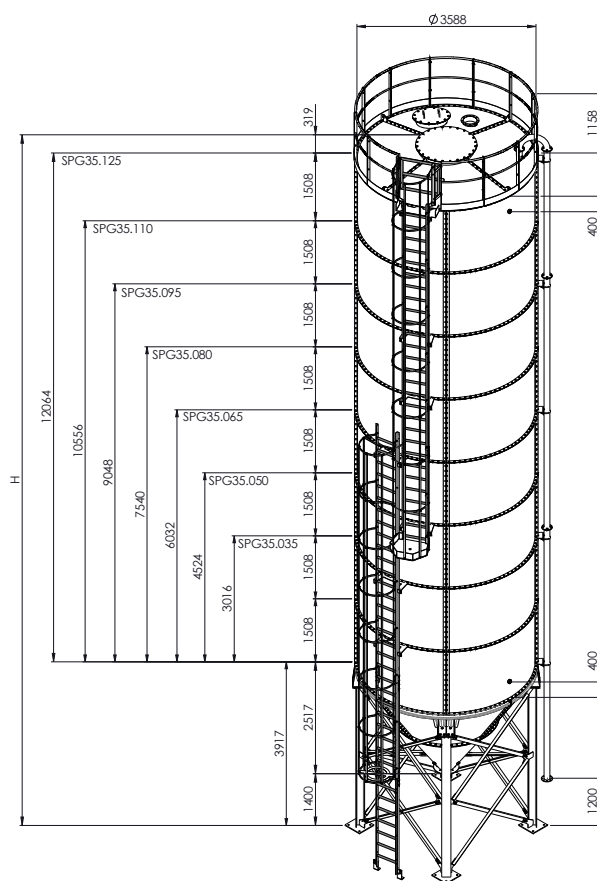

TYPE	Silo Capacity (m³)	Ferulles (qty.)	Panel (qty.)	Total Height (mm)	Net weight (kg)	
					SEISMIC ZONE ZS1 (0.40g)	SEISMIC ZONE ZS2 (0.25g)
SPG35.020	20	1	4	5744	3,907	3,049
SPG35.035	35	2	8	7252	4,608	3,540
SPG35.050	50	3	12	8760	5,425	4,040
SPG35.065	65	4	16	10268	6,194	4,672
SPG35.080	80	5	20	11776	7,021	5,225
SPG35.095	95	6	24	13284	7,720	5,944
SPG35.110	110	7	28	14792	9,065	6,631
SPG35.125	125	8	32	16300	9,757	7,181
SPG35.140	140	9	36	17808	11,497	not available

Benefits

- ✓ Pre-equipped for several types of venting filters, outlet valves, cone aeration systems, level and pressure monitoring devices.
- ✓ Packing designed to minimise shipping costs.
- ✓ Modular system that simplifies shipping, installation and dismantling.
- ✓ Large number of items available from stock.

Features



Silos designed and engineered in compliance with the standards in force related to wind, snow, and seismic activities.



Large variety of application layouts; supervising during assembly through global WAMGROUP® network.



Carefully selected materials and industrial manufacturing processes resulting in a high-quality product in the tradition of artisan expertise.



Certified products provided with all necessary technical documentation.

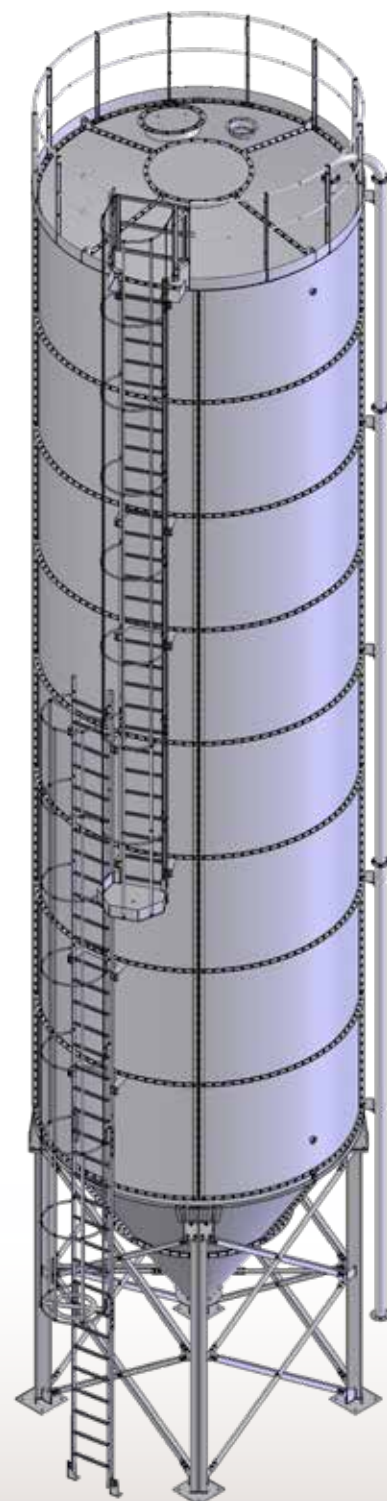

Bottom Cone Options and Aeration

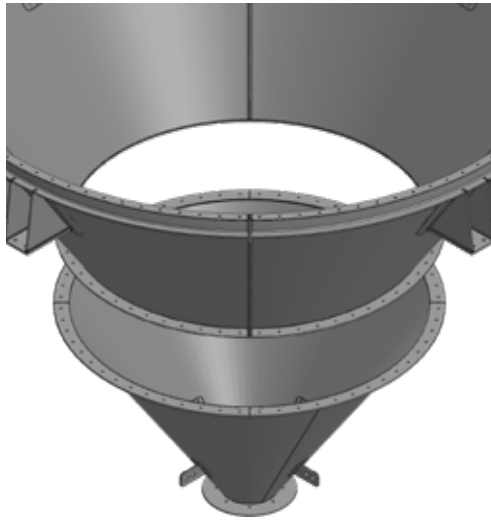

Standard 56° bottom cone

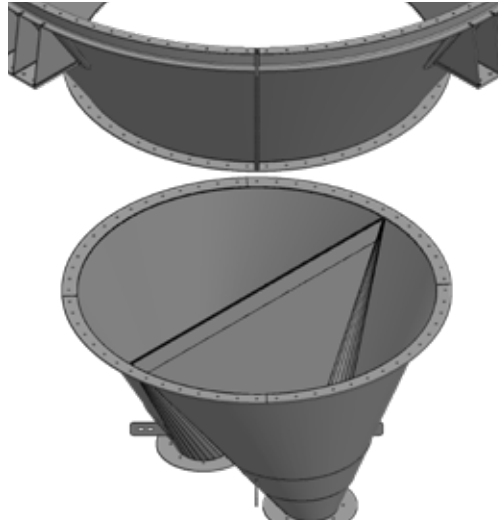

Twin outlet cone

OLI® PRODUCT	CODE	HOLES qty.	Ø mm
	F04	4	14
	F08	8	14
	F12	12	14
	V04	4	23
	V08	8	23
	V12	12	23

OLI® PRODUCT	CODE	BOSSES qty.	Dimension in
	M04	4	2" with plugs
	M08	8	2" with plugs
	M12	12	2" with plugs
	S04	4	1" with plugs
	S06	6	1" with plugs
	S08	8	1" with plugs
	S12	12	1" with plugs

Bin Activator Pre-arrangement

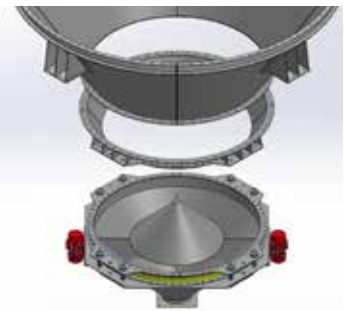
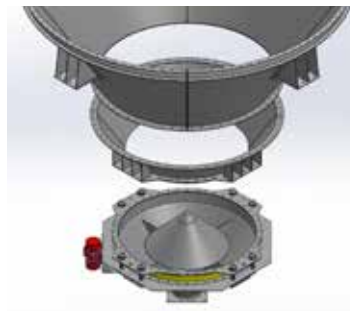
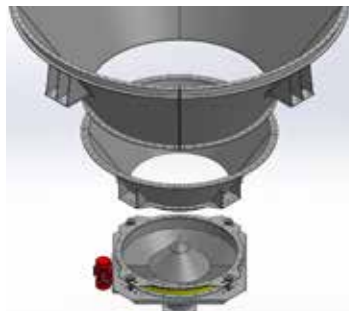
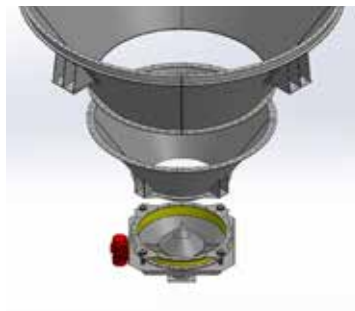

EXTRAC® BA 100 pre-arrangement EXTRAC® BA 125 pre-arrangement EXTRAC® BA 150 pre-arrangement EXTRAC® BA 180 pre-arrangement

Support Frames

All support frames are suitable for seismic zone 1 (0.40g) and 2 (0.25g)

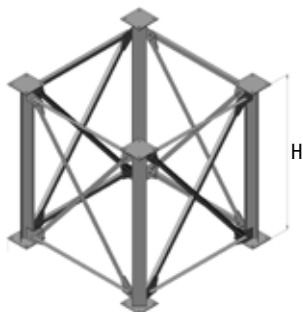

CODE		Distance from outlet to ground (mm)	Frame height (mm)	MODULE		
without service platform	with service platform			H = 1,710 (mm)	H = 2,280 (mm)	H = 2,280 (mm)
STS1S	STP1S	3,110	1,710	X		
STS2S	STP2S	3,680	2,280		X	
STS3S	STP3S	4,250	2,850			X
STS4S	STP4S	4,820	3,420	XX		
STS5S	STP5S	5,960	4,560		XX	
STS6S	STP6S	7,100	5,700			XX
STS7S	STP7S	5,390	3,990	X	X	
STS8S	STP8S	5,960	4,560	X		X
STS9S	STP9S	6,530	5,130		X	X

Truck Loading Platforms

SILOFAB™ supplies truck loading platforms for single silos as well as battery configurations.

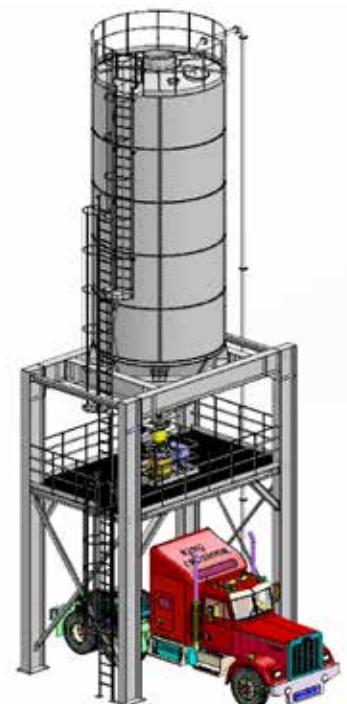

Application



INDUSTRIES

- Concrete Production
- DryMix Building Materials
- Asphalt Plants
- Sludge Treatment
- Foundries
- Glass Processing
- Paint Production
- Flour Milling
- Rice Milling
- Lime & Gypsum Processing
- Refractory Processing
- Brick & Roof Tile Production
- Ceramics Production

Quality



9001:2015

Quality Management Systems



Environmental Management Systems



ISO 45001:2018

Occupational Health And Safety Management Systems



Quality Management Customer Satisfaction



Execution of Steel Structures and Aluminium Structures



Quality Requirements for Fusion Welding of Metallic Materials

Robotic Welding Station







Welding







- Welding coordination personnel - International Welding Engineer (IWE & EWE)
- NDT personnel certified according to ISO 9712
- Welders certified according to ISO 9606-1
- WPS supported by WPQR available at workstations

Shipping Space Calculation

Space calculation for seismic zone 1 (0.40g) bolted silos

SILO TYPE	TRANSPORT REQUIREMENTS FOR 1 SILO		TRANSPORT REQUIREMENTS FOR 2 SILOS	
	Road Transportation	Maritime Transportation	Road Transportation	Maritime Transportation
	 L 13.6 X 2.45 X 2.70	 Open Top Container	 L 13.6 X 2.45 X 2.70	 Open Top Container
SPG35.020	7.0 m	1 x 40" OT	11.0 m	1 x 40" OT + 1 x 20" OT
SPG35.035	8.5 m	1 x 40" OT	11.0 m	1 x 40" OT + 1 x 20" OT
SPG35.050	8.5 m	1 x 40" OT	12.0 m	1 x 40" OT + 1 x 20" OT
SPG35.065	8.5 m	1 x 40" OT	1 truck	1 x 40" OT + 1 x 20" OT
SPG35.080	8.5 m	1 x 40" OT	1 truck	2 x 40" OT
SPG35.095	11.0 m	1 x 40" OT + 1 x 20" OT	1 Truck + 3 m	2 x 40" OT
SPG35.110	11.0 m	1 x 40" OT + 1 x 20" OT	1 Truck + 3 m	2 x 40" OT
SPG35.125	11.0 m	1 x 40" OT + 1 x 20" OT	1 Truck + 6 m	2 x 40" OT
SPG35.140	11.0 m	1 x 40" OT + 1 x 20" OT	1 Truck + 6 m	2 x 40" OT

Space calculation for seismic zone 2 (0.25g) bolted silos

SILO TYPE	TRANSPORT REQUIREMENTS FOR 1 SILO		TRANSPORT REQUIREMENTS FOR 2 SILOS	
	Road Transportation	Maritime Transportation	Road Transportation	Maritime Transportation
	 L 13.6 X 2.45 X 2.70	 Open Top Container	 L 13.6 X 2.45 X 2.70	 Open Top Container
SPG35.020	7.0 m	1 x 40" OT	11.0 m	1 x 40" OT
SPG35.035	8.5 m	1 x 40" OT	11.0 m	1 x 40" OT
SPG35.050	8.5 m	1 x 40" OT	12.0 m	1 x 40" OT + 1 x 20" OT
SPG35.065	8.5 m	1 x 40" OT	1 truck	1 x 40" OT + 1 x 20" OT
SPG35.080	8.5 m	1 x 40" OT	1 truck	1 x 40" OT + 1 x 20" OT
SPG35.095	11.0 m	1 x 40" OT	1 Truck + 3 m	2 x 40" OT
SPG35.110	11.0 m	1 x 40" OT	1 Truck + 3 m	2 x 40" OT
SPG35.125	11.0 m	1 x 40" OT + 1 x 20" OT	1 Truck + 6 m	2 x 40" OT

2 off 80m³ silos
loaded on a single truck

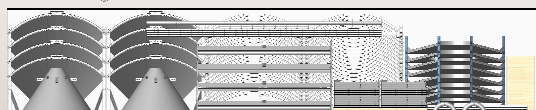
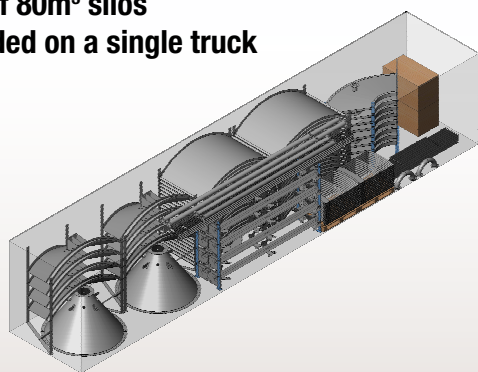

2 off 80m³ silos seismic zone 2 (ZS2)
loaded into a container

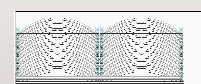
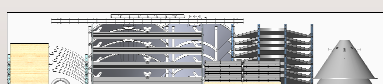
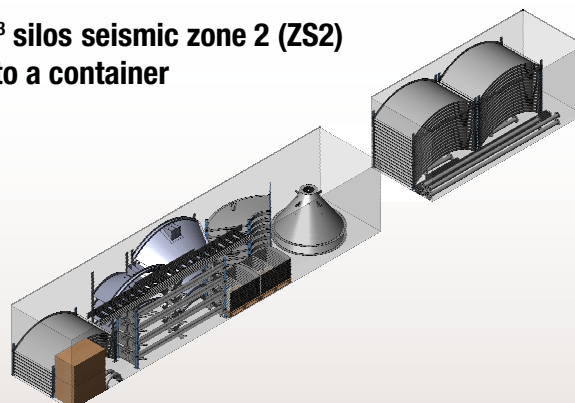

Application



SILOFAB™ Standard External Colour Selection

RAL 7035	RAL 1013	RAL 2009	RAL 5010	RAL 5012	RAL 6011	RAL 7001
RAL 7032	RAL 7044	RAL 9001	RAL 9002	RAL 9003	RAL 9010	



203001797 September 2020 Rights reserved to modify technical specifications.

This brochure has been edited for distribution in European Union countries



SILOFAB



www.silofab.com