



NEW
from iwis

ELITE Baler Chain Series HBC



The new **ELITE Roller Chain Series HBC (Heavy Baler Chain)** was specially developed by iwis for heavy-duty baler applications. HBC Roller Chains are a perfect combination of **superlative fatigue strength** and **extremely high wear resistance**, yet only require the same space as standard roller chains.

Highlights

- All link plates with a higher proportion of clean-cut edges offer longer chain service life and higher retention forces for greater stability.
- Reduced wear with no change to chain dimensions due to high performance steels and optimized heat treatment process.
- Optimised plate contours and special materials offer higher fatigue strength compared to the same size of standard chain.
- Premium quality initial lubricant designed to meet the requirements of baler conditions.
- Longer maintenance / chain replacement intervals can be attributed to the best ratio of fatigue strength and wear resistance currently available in the market.



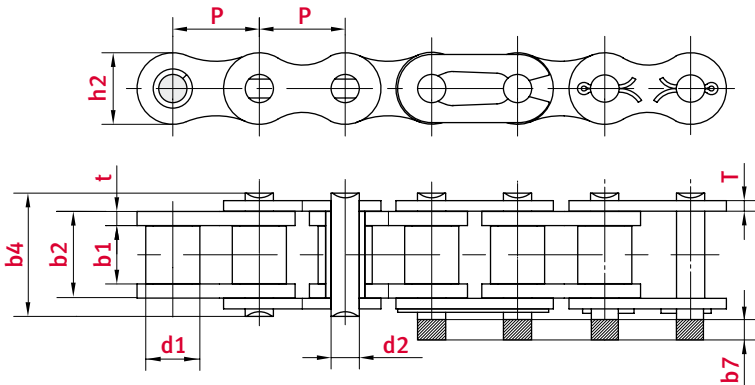

Chain type	Pitch	Width between inner plates	Roller Ø	Pin Ø	Total width inner link	Pin length	Max. add. length of connecting link	Plate thickness	Height inner plate	Bearing surface	Min. Tensile strength
	p mm	b1 min. mm	d1 max. mm	d2 max. mm	b2 max. mm	b4 max. mm	b7 max. mm	t / T mm	h2 max. mm	cm²	F min. KN
ANSI 60 H	19.05	12.57	11.91	5.96	19.43	30.2	4.6	3.2	18.1	1.16	31.3
ANSI 80 H	25.4	15.75	15.88	7.94	24.28	37.4	5.4	4.0	24.13	1.93	55.6
ANSI 100 H	31.75	18.9	19.05	9.54	29.1	44.5	6.1	4.8	30.17	2.78	87.0
ANSI 60 HV	19.05	12.57	11.91	5.96	19.43	30.2	4.6	3.2	18.1	1.16	55.0
ANSI 80 HV	25.4	15.75	15.88	7.94	24.28	37.4	5.4	4.0	24.13	1.93	80.0
ANSI 100 HV	31.75	18.9	19.05	9.54	29.1	44.5	6.1	4.8	30.17	2.78	133.4
ANSI 60 HBC	19.05	12.57	11.91	5.96	19.43	30.2	4.6	3.2	18.1	1.16	40.0
ANSI 80 HBC	25.4	15.75	15.88	7.94	24.28	37.4	5.4	4.0	24.13	1.93	65.0
ANSI 100 HBC	31.75	18.9	19.05	9.54	29.1	44.5	6.1	4.8	30.17	2.78	100.0

NEW

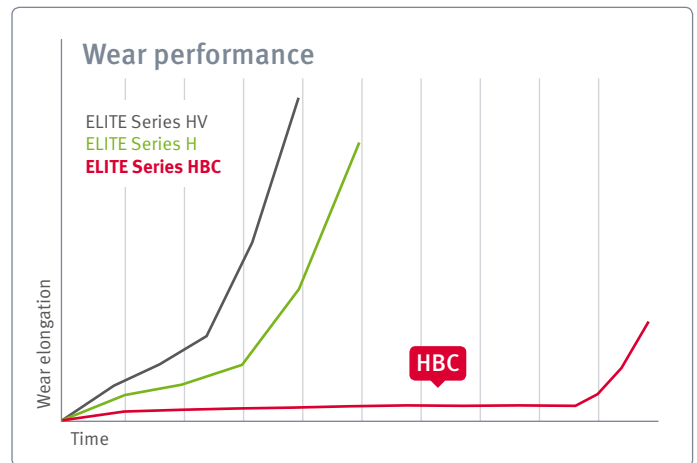
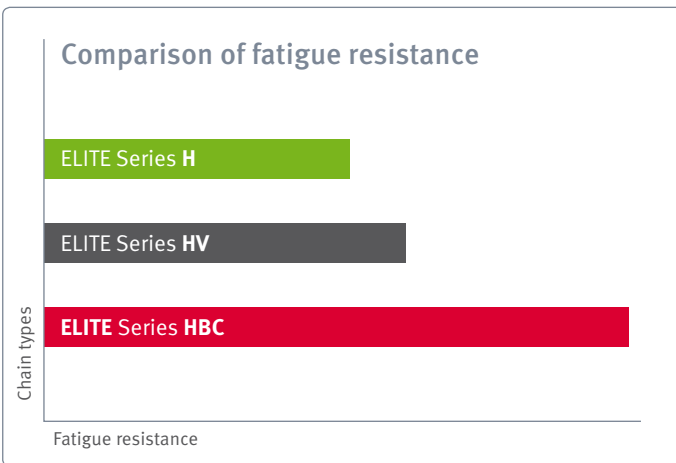

Printed: WB 10/2015